



Don't Get Rejected – Best Practices for Location Sketch Maps

Presented by: Ramona Monroe, Shannon Bleicher, Andrea Jacuk

2024 Alaska Miners Association Convention

November 5, 2024





Overview

1. Why It Matters

2. Legal Requirements

3. Case Studies

4. Tools For Success



Stoel Rives^{LLP}

Legal Requirement for Claim Sketch Maps



Alaska Statute 38.05.195

(c) A locator's corners shall be distinctly marked on the ground in the manner prescribed by the commissioner, and a notice of location shall be attached to a monument at the claim's northeast corner in the manner and containing the information required by the commissioner. Within 45 days after the date of attaching the notice of location on the monument, the locator shall record a certificate of location in the recording district where the claim is located. The certificate must contain the information required by the commissioner.

11 AAC 86.215 Certificate of Location -

Summary

- (a) Within 45 days after the date of posting of the notice of location, a locator shall record a certificate of location in conformance with AS 38.05.195. The certificate of location must be recorded in the recording district in which the location is situated, on a form approved by the department or on a substantially similar form meeting the recording requirements of 11 AAC 06.040, and must include:
- 1) The name or number of the location;
 - 2) The dates of discovery and posting;
 - 3) For a traditional location, the length and width of the location in feet, and each meridian, township, range, section, quarter-section of the location;
 - 4) For an MTRSC location, the meridian, township, range, section, quarter-section, and if applicable the quarter-quarter-section of the location;
 - 5) The name, mailing address, and signature of each locator or locator's agent;
 - 6) Recording district in which the location is situated; and
 - 7) A map depicting and identifying particular information.



Claim Sketch Map Requirements

11 AAC 86.215(a)(7) identifies the information the Commissioner requires be included in the map accompanying a certificate of location. The map must include:

- an indicated scale of 1:63,360 (one inch = one mile) or a more detailed scale
- shows the boundaries of the claim or leasehold location
- the dominant physical features of the land
- the surveyed section line or, if unavailable, the protracted section lines surrounding the location
- to the best of the locator's knowledge, the relationship of the location to adjacent or contiguous mining claims, leasehold locations, mining leases, prospecting sites, mineral orders, and non-state land;
- if the locator is simultaneously recording contiguous locations, a single map showing all locations may be attached to one of the certificates of location and that certificate must be cross-referenced on each other certificate of location to which the map applies.



Possible Oversights

- Scale mismatch or incorrect scale
- Boundaries not depicted (not apparent when map copied to black and white)
- Dominant features not depicted (left off map or not apparent when map copied to black and white)
- Fail to include section lines surrounding the location (complete section where claims are located)
- Recording district mismatch



“to the best of the locator’s
knowledge”

- The map must include “to the best of the locator's knowledge, the relationship of the location to adjacent or contiguous mining claims, leasehold locations, mining leases, prospecting sites, mineral orders, and non-state land”
- DNR has created a tool that will help you create a map that includes this information
- The “best of the locator’s knowledge” is assumed to be the information available in DNR’s mapping tool
- Cannot claim not to know, if the information is listed in Alaska Mapper claim sketch map tool, you should consider including it



Map of contiguous locations

- If the locator is simultaneously recording contiguous locations, a single map showing all locations may be attached to one of the certificates of location and that certificate must be cross-referenced on each other certificate of location to which the map applies.
- Remember, the map must still meet the other requirements.
- If your claim group is too large, consider recording two or three maps so that sufficient details can be depicted.

Practical Tips

- Make sure that your map matches your location certificate(s)
- Include claim names on map - scale sufficient so that claim names are legible
- Colored images may not be legible due to scanning/recording process
- Image compressed for recording - level of detail you want to appear in the public record
- Surrounding sections - not full sections but enough to show surrounding lands
- Think Goldilocks - not too much detail, not too little detail



Stoel Rives_{LLP}

Case Studies

Case Study #1

What we might see on Mapper

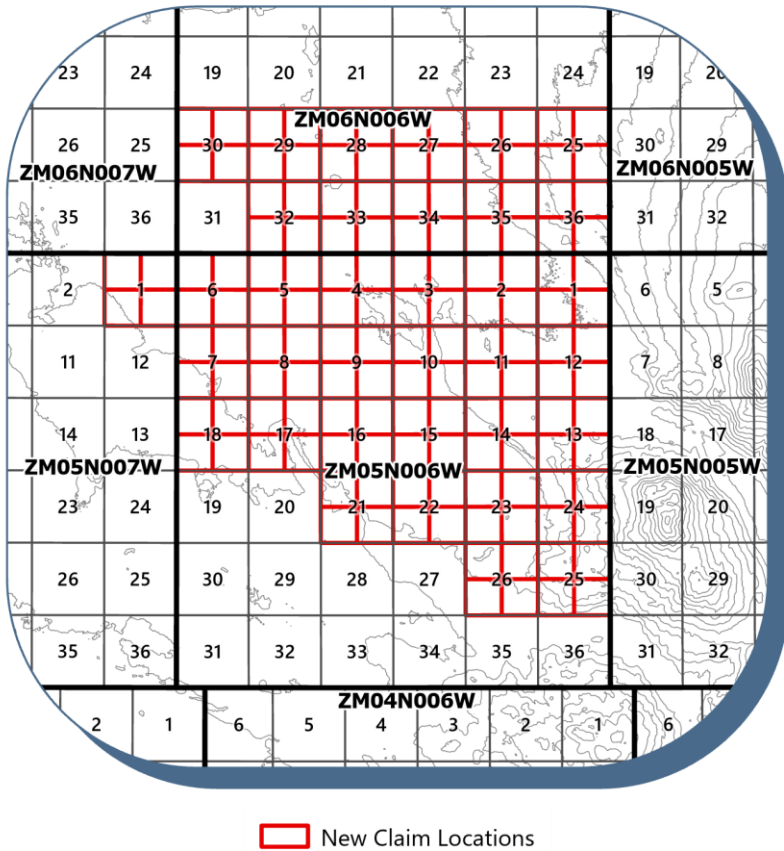

Claim Sketch

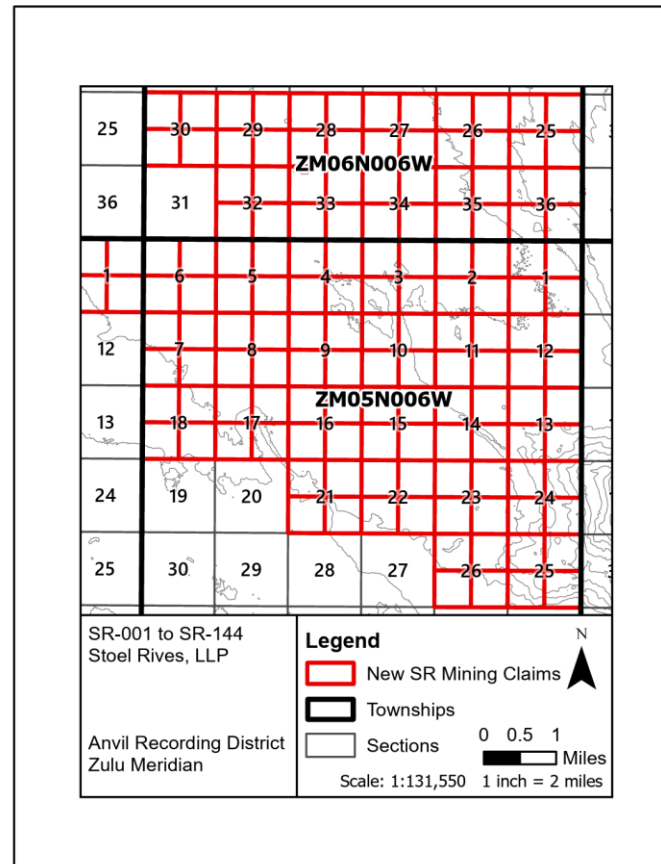

Is this sufficient?

Case Study #1

What we might see on Mapper

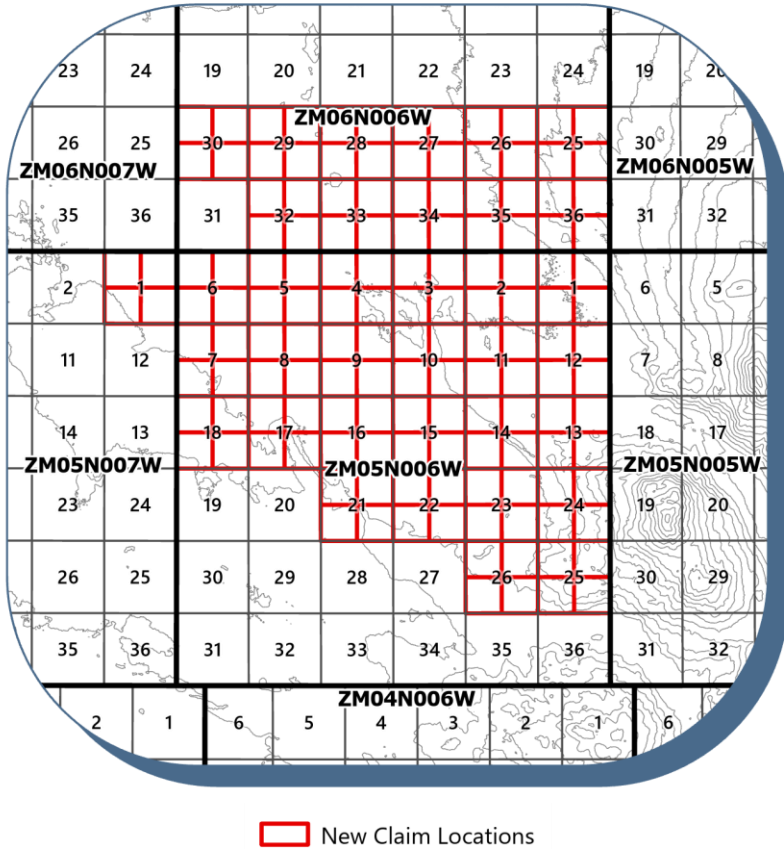

Claim Sketch

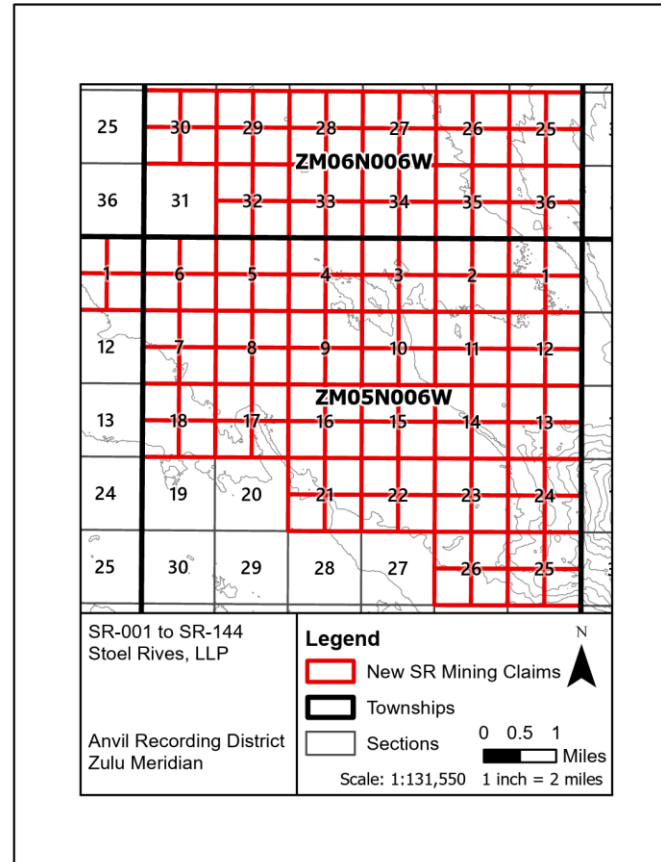

Is this sufficient?

No.

- x Full section lines not displayed
- x All townships are not labeled
- x Claim names are not labeled
- x Map scale does not meet regulations.
- x Will not properly record.

Case Study #2

What we might see on Mapper

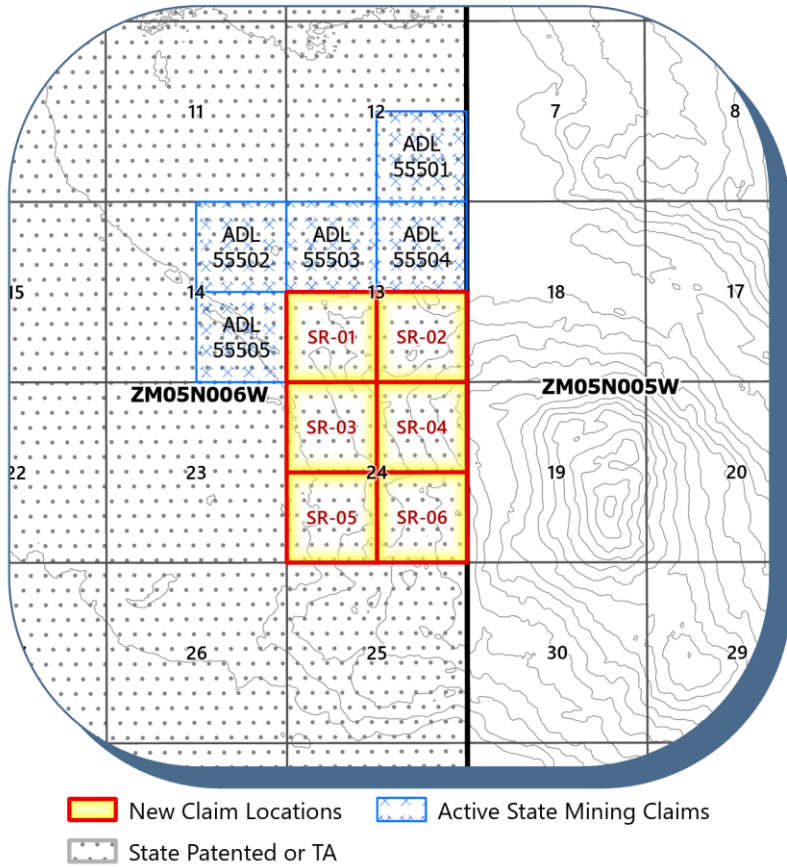

Claim Sketch

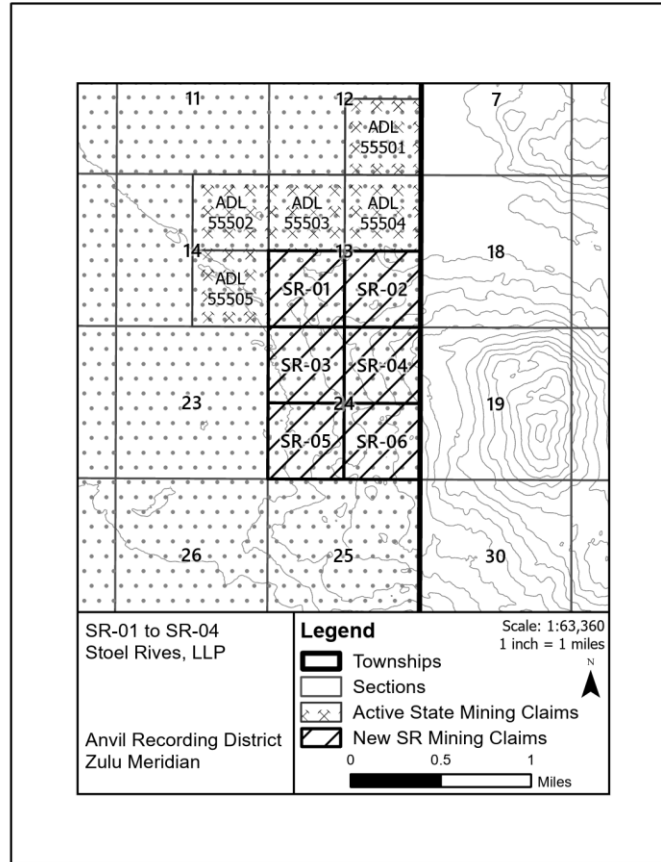

Is this sufficient?

Case Study #2

What we might see on Mapper

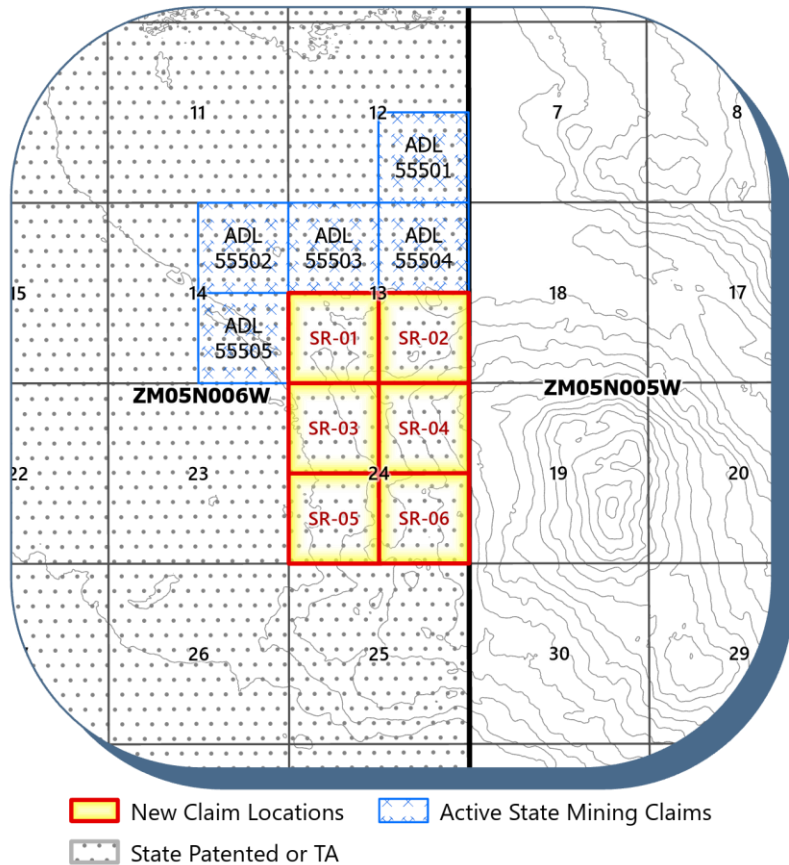

Claim Sketch

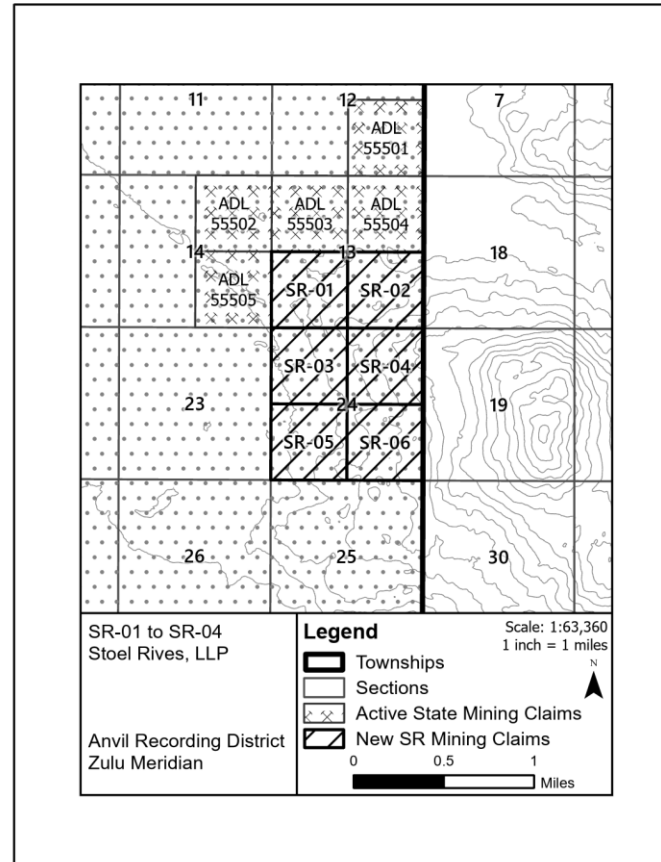

Is this sufficient?

No.

- ✓ Adjacent claims are labeled.
- x State land is not labeled.
- x Meridian, Township, Range are not labeled.

Case Study #3

What we might see on Mapper

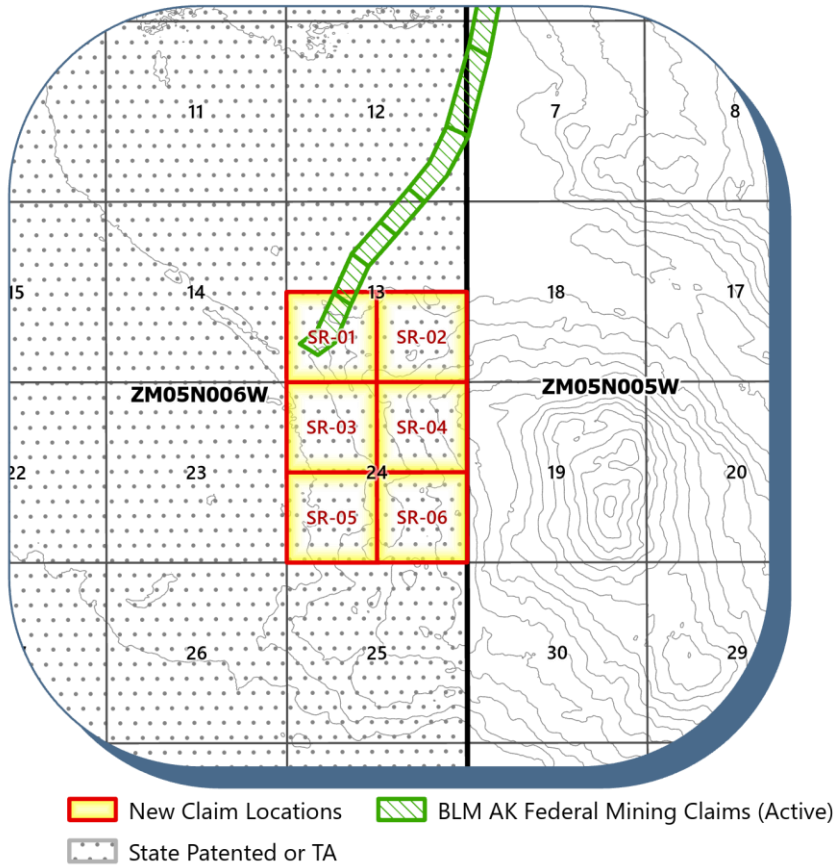

Claim Sketch

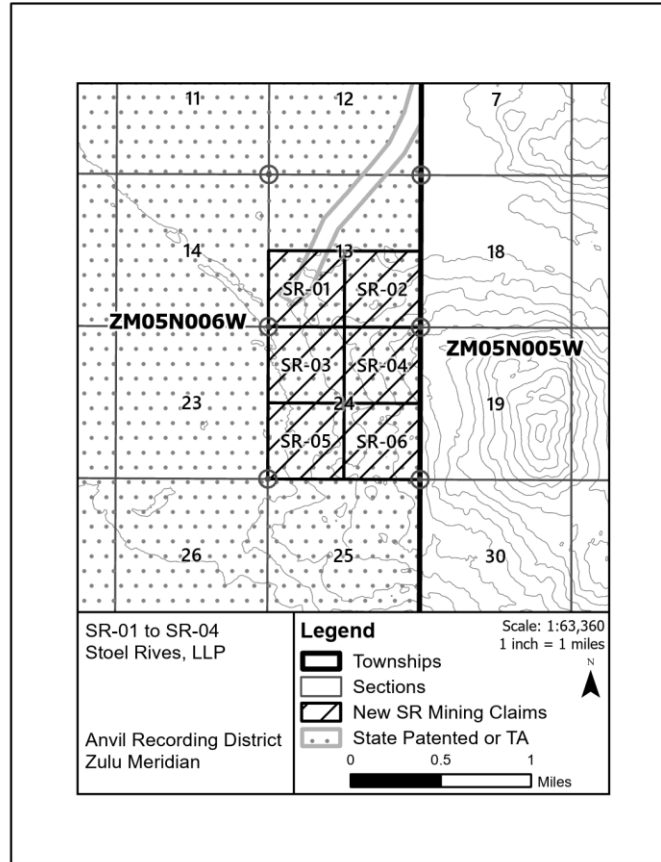

Is this sufficient?

Case Study #3

What we might see on Mapper

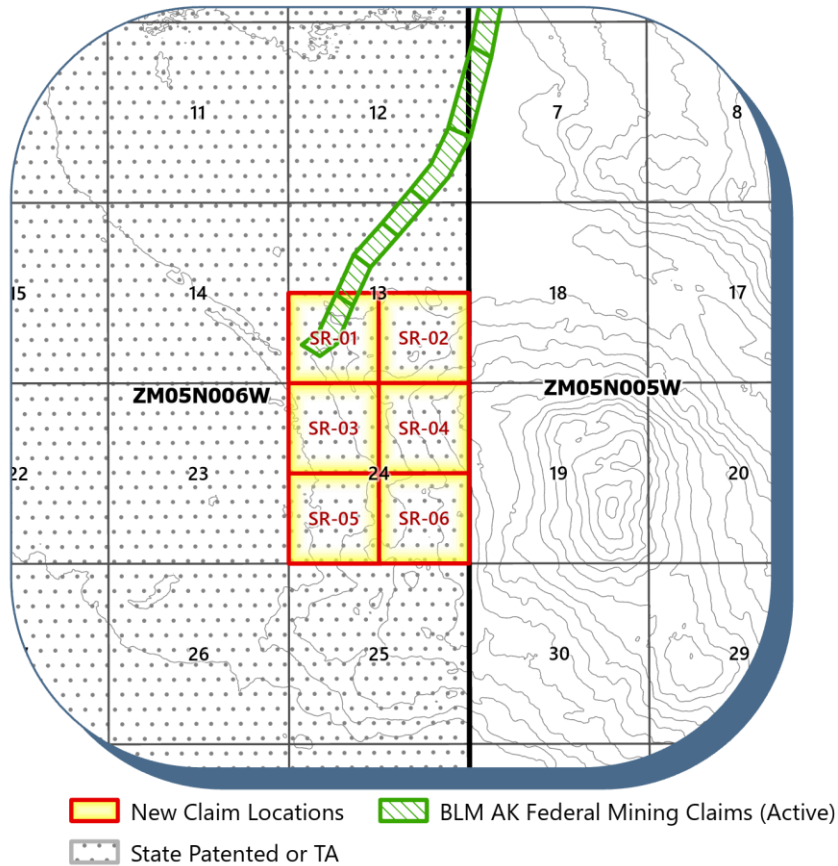

Claim Sketch

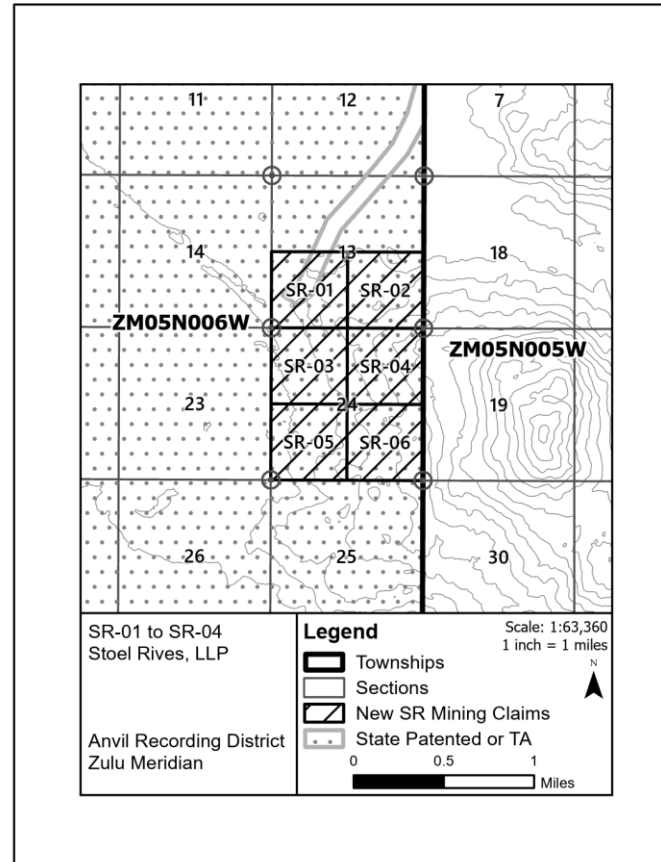

**Is this sufficient?
Not likely.**

- ✓ MTRS are labeled
- ✓ State land is labeled
- x Includes unnecessary information
- x Does not exclude valid and existing rights

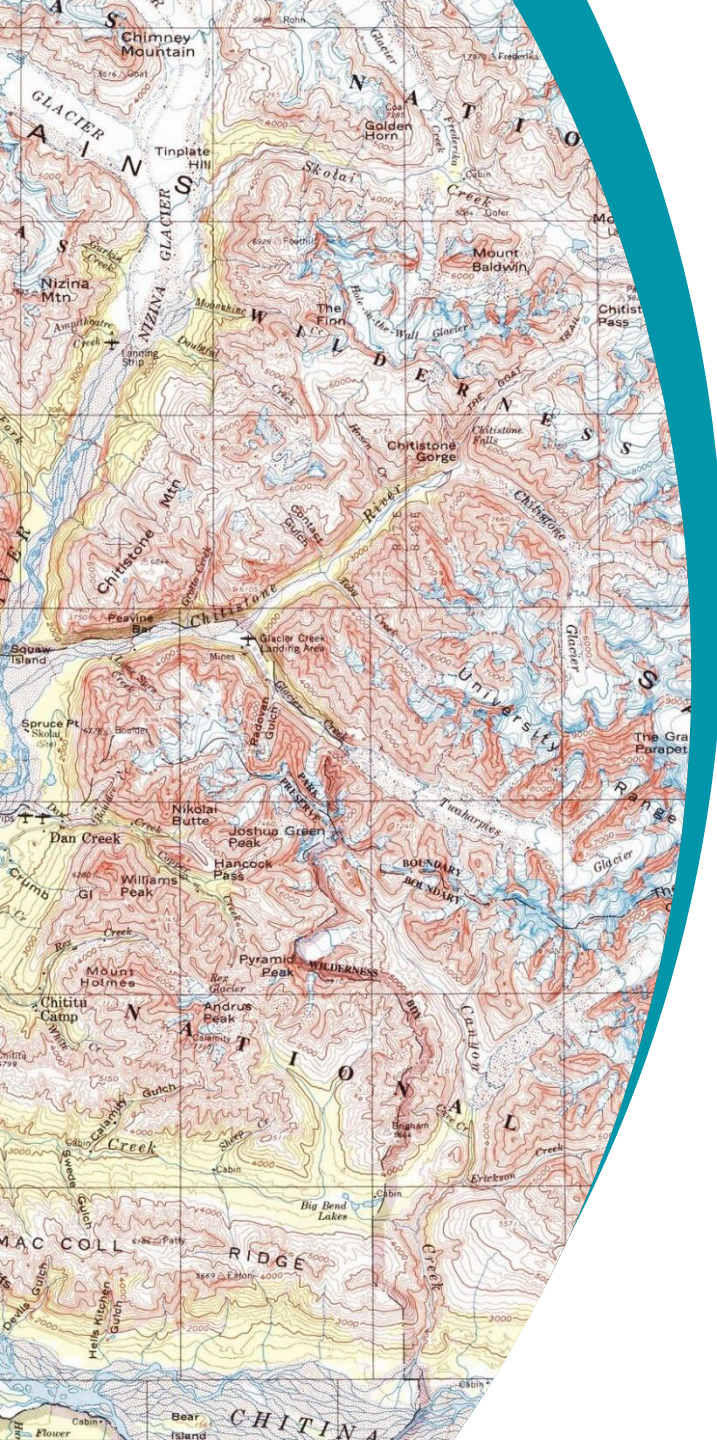

Valid and Existing Rights (MTRSC)

- Non-state land (*Federal mining claims, State-Selected, Mental Health Trust*)
- Active mining claims
- Existing roads, rights of way, encumbrances
- Other

Method 1

"Carve out" existing rights from claim boundary.

Method 2

BEST PRACTICE

*PRACTICE**

**BEST*

Maintain original claim boundary.
Include disclaimer on location certificate and sketch map.

Revised 01/22
DNR 10-162V
MTRSC

STATE OF ALASKA
DEPARTMENT OF NATURAL RESOURCES
STATE MINING LOCATION NOTICE / CERTIFICATE
(FOR MTRSC LOCATIONS ONLY)

LOCATION NAME/NUMBER: _____ DISCOVERY DATE: _____

LOCATOR INFORMATION:
(The locator is the owner. Print the Name / Address below where correspondence should be sent. Asterisk items are optional):

1. Owner's Name: _____ POSTING DATE: _____
Mailing Address: _____ SIZE OF LOCATION (check one)
City, State Zip: _____ FULL Quarter Section (160 acres): _____
*Contact Phone: _____ Quarter-Quarter Section (40 acres): _____
*E-mail: _____ RECORDING DISTRICT: _____
LEGAL DESCRIPTION:
Give the complete legal description below.

ADDITIONAL LOCATOR'S / OWNER'S (PRINT)

2. Owner's Name: _____ Meridian: _____
Mailing Address: _____ Township: _____
City, State Zip: _____ Range: _____
*Contact Phone: _____ Section: _____
Email: _____ Quarter Section: _____
CREEK NAME: (optional) Qtr-Qtr Section (if 40 acres) _____ of _____

LOCATION EXCLUDES ALL VALID AND EXISTING RIGHTS

ALL OWNERS OR THEIR AGENTS MUST SIGN:
I hereby verify that the owner(s) listed above are qualified to hold mineral rights in Alaska per the requirements of AS 38.05.190, and on the date above, a location notice was posted on the monument at the NE corner of this claim, to the best of my knowledge, and in accordance with applicable State statutes and regulations.

1. Owner / Agent: _____ CLAIM SKETCH:
2. Owner / Agent: _____ (See instructions on reverse side.) A separate map, at a scale of 1:63,360 (one inch = 1 mile), is to be provided showing the boundaries of the location, the dominant physical features, the section lines, and to the best of the locator's knowledge the relationship to other mineral locations, mineral orders, and non-state land.

Print Agent's Name: _____ Attached to this certificate. Attached to the certificate for the following location:
Attach an extra sheet for Additional Owners and Signatures Location name or number

The information provided on this form is made a part of the state public land records and becomes public information under AS 40.25.110 and 40.25.120. Public information is open to inspection by you or any member of the public. A person who is the subject of the information may challenge its accuracy or completeness under AS 40.25.310, by giving a written description of the challenged information, the changes needed to correct it, and a name and address where the person can be reached.

\$165.00 Qtr Section of a Township First Rental. \$40.00 Qtr-Qtr Sec. of a Township First Rental. Div of Mining, Land & Water Use: ADL Receipt Type: 80
Due Within 45 Days Of Posting.



Stoel Rives_{LLP}

Tools for Success

Alaska Mapper to the Recorder's Office

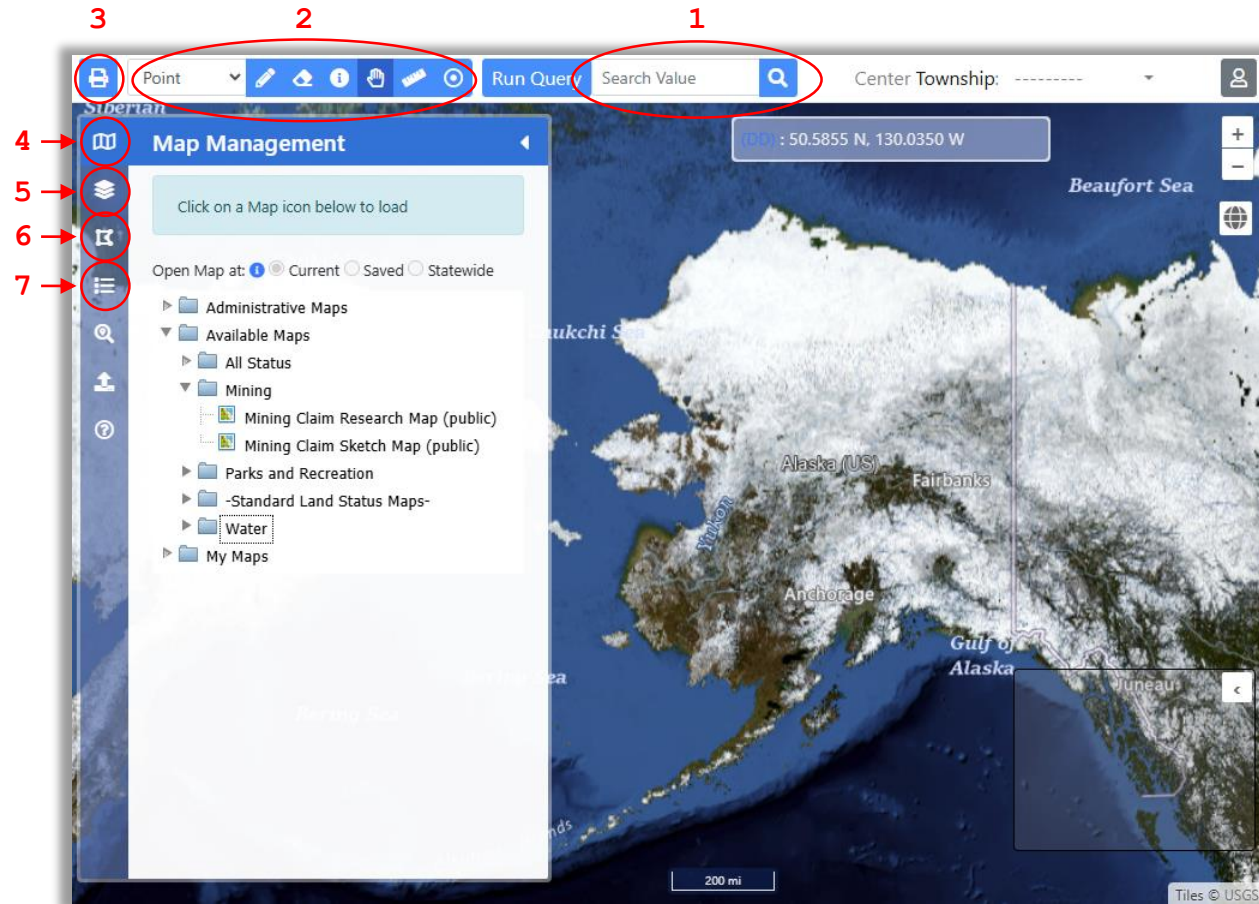

Alaska Mapper:
mapper.dnr.alaska.gov

- Research Map vs Sketch Map
- Note how land ownership is displayed

Navigating Mapper:

1. Search
2. Drawing tools
3. Print
4. Map Management - choose your map
5. Layer Management - change basemap, add and remove map layers and labels
6. Manage drawn features
7. Legend

Alaska Mapper to the Recorder's Office

- Research
- Print
- Draw and label mining claims
- Include legend if required
- Make sure margins are at least 1-inch

Always reference the applicable regulations before recording a location certificate claim sketch.

Common errors:

- Layers will not display in black and white
- Map scale bar is not depicted or at incorrect scale (closer or equal to 1 in. = 1 mi.)
- Layers are not labeled or otherwise called out

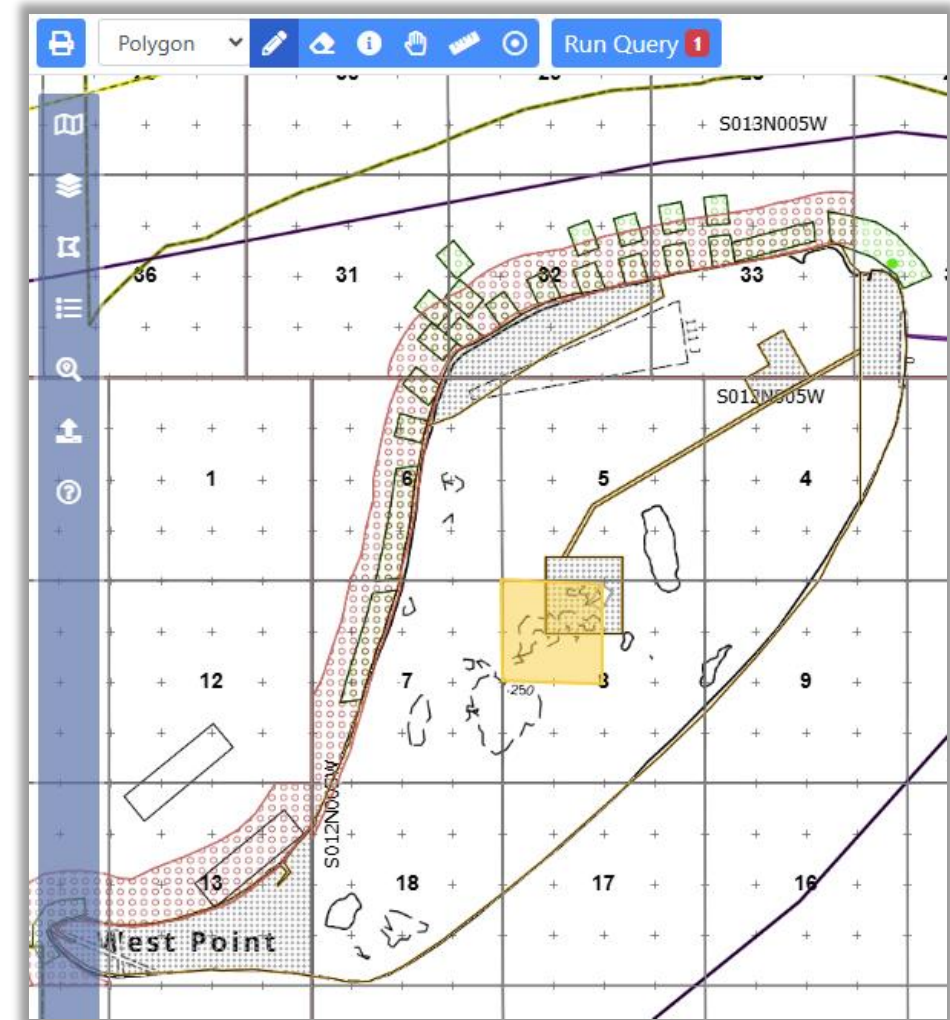

Best Practices

- Double check that your location certificate and claim sketch map include each of the items required in 11 AAC 86.215.
- Use the Alaska Mapper tools available to ensure that your map includes the necessary information about the lands within your location and surrounding lands.
- If location posted after June 15th: pay 1st and 2nd year rents at the time of recording location notice.
- With sufficient notice, DNR will review your map prior to recording
 - dnr.dmlw.mpm@alaska.gov

Questions?



Ramona Monroe

PARTNER

ramona.monroe@stoel.com



Shannon Bleicher

ATTORNEY

shannon.bleicher@stoel.com



Andrea Jacuk

LAND MANAGER

andrea.jacuk@stoel.com